



www.sabta-lb.com



SabtaInvestment



SabtaInvestment

READY TO MOVE IN



Mob. +961 70 333 508  
Tel. +961 1 745 996/7  
Fax +961 1 745 988  
Mail info@sabta-lb.com

SABTA  
4461







SABTA 775

SABTA 4461

SABTA 4464





Sabta 4461, in Debbieh, is located roughly :

- 30 Km south of Beirut
- 28km north of Saida
- 6km from nearest beach resorts
- Debbieh is 450m above sea level
- Bordered by the towns of Saadiyat , Dahr Lemghara Bourjein with a breathtaking mountainous views



Beirut Arab University- Debbieh : 3 min  
جامعة بيروت العربية - الدبية : ٣ دقائق



Lebanese University- Debbieh : 5 min  
الجامعة اللبنانية - الدبية : ٥ دقائق



Beach Resorts- Damour : 8 min  
المنتجعات البحرية - الدامور : ٨ دقائق

## 25MIN FROM BEIRUT

يقع مشروع ٤٤٦١ في الدبية والتي تبعد

- ٣٠ كلم جنوب مدينة بيروت
- ٢٨ كلم شمال مدينة صيدا
- ٦ كلم عن المنتجعات البحرية
- ترتفع بلدة الدبية ٤٥٠ مترا عن سطح البحر
- تحدها كل من بلدتي السعديات و ضهر المغارة من الشرق والجنوب، بلدة البرجين من الغرب والشمال

# THE LOCATION







**SABTA** projects are located with 25 minutes' drive from Beirut, in a peaceful surrounding overlooking mountainous view.

Near all the facilities set to be :

- 3mins from Beirut Arab University
- 5mins from Lebanese university

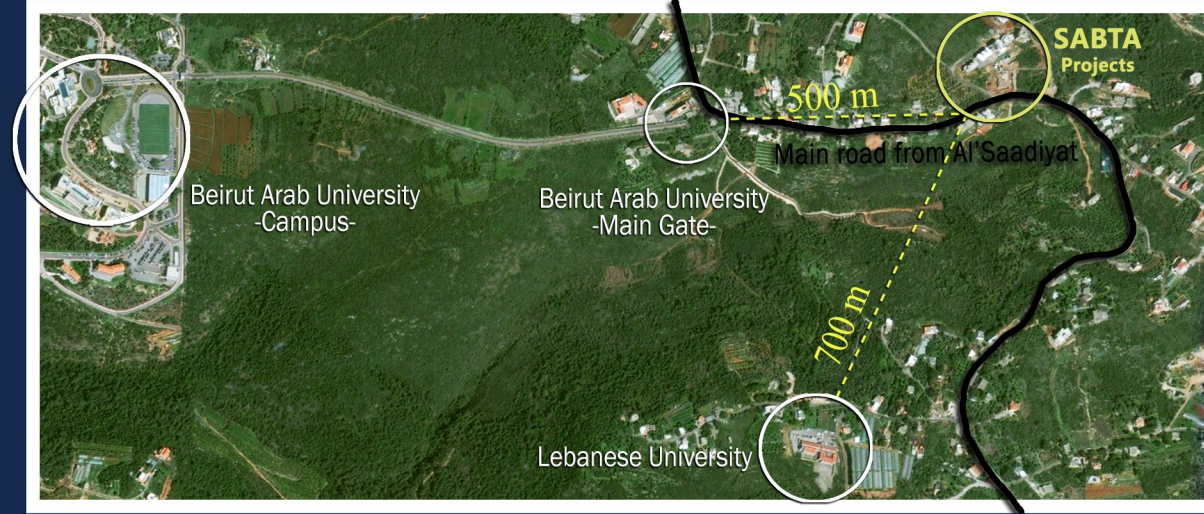

# THE LOCATION

مشاريع سبتا بتصاميمها الحديثة مؤلفة من ٤ طوابق و تتميز:

- بوقوعها على الطريق العام
- بقربها من الجامعة العربية والجامعة اللبنانية في منطقة الدبية
- باطلالتها على الجبل بحيث تجعل منها بيئة مثالية لحياة هادئة.





# SABTA 4461



## PROJECT'S INTRODUCTION





# PROJECT'S BRIEF



Our residential units boasts in :

- 15 Apartments
- 4 Floors
- 2 Retails Section
- 17 Parking Lots

يتألف المشروع من :  
• ١٥ شقة سكنية  
• ٤ طوابق  
• محلين تجارين  
• ١٧ موقف سيارات

## SABTA 4461





NIGHT  
FACADE



SABTA  
4461





# PROJECT'S LANDSCAPE



# SABTA 4461





# PROJECT'S LANDSCAPE



# SABTA 4461





VIEW FROM  
INTERIOR

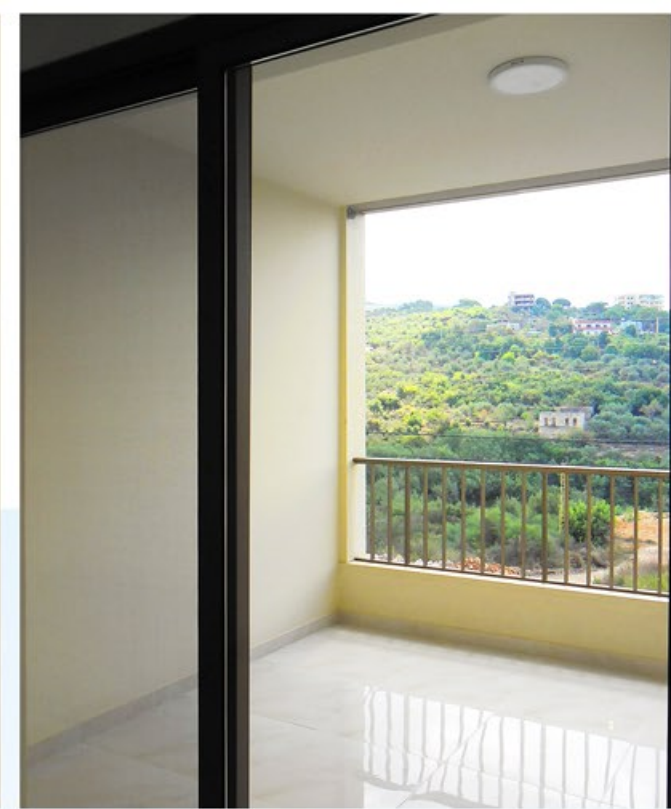

SABTA  
4461





# INTERIOR DETAILS

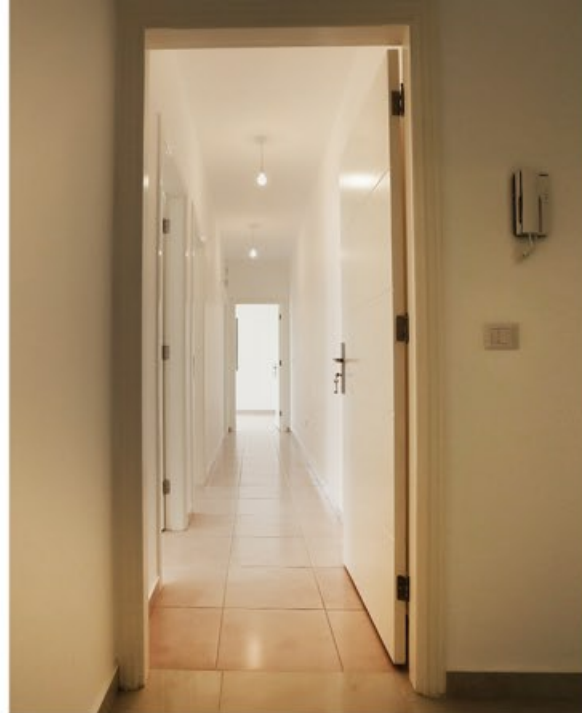

# SABTA 4461



# PROJECT'S FLOOR PLAN



- Apartments are distributed among 4 floors
- Each floor boasts in a total of 4 apartments of areas ranging from 104 m<sup>2</sup> to 132 m<sup>2</sup>

- تتوزع الشقق في المشروع على ٤ طوابق
- يشمل الطابق ٤ شقق بمساحات مختلفة تتراوح من ١٠٤م<sup>٢</sup> إلى ١٣٢م<sup>٢</sup>

## APARTMENTS AREAS TYPICAL FLOOR

Apartment 01 3 Bedrooms 132m<sup>2</sup>

Apartment 02 2 Bedrooms 109m<sup>2</sup>

Apartment 03 2 Bedrooms 104m<sup>2</sup>

Apartment 04 3 Bedrooms 127m<sup>2</sup>

# SABTA 4461

APARTMENT 02

APARTMENT 03



APARTMENT 01

APARTMENT 04



## TYPICAL FLOOR PLAN



# UNIT'S DETAILS



## Apartment 01 [ TYPICAL FLOOR ]



Apartment 01 - boasts 3 bedrooms and a spacious open-plan living area to a balcony with mountainous view

132 sqm

Lobby	2.1 x 4.8 m
Salon & Dining	6.9 x 3.4 m
Balcony	2.9 x 3.4 m
Guest Bathroom	2.1 x 1.3 m
Kitchen	2.5 x 3.0 m
Bedroom 1	3.2 x 3.5 m
Bedroom 2	3.2 x 3.5 m
Main Bathroom	1.3 x 2.1 m
Bedroom 3	3.3 x 3.4 m

**Apartment Area 132 m<sup>2</sup>**

# SABTA 4461

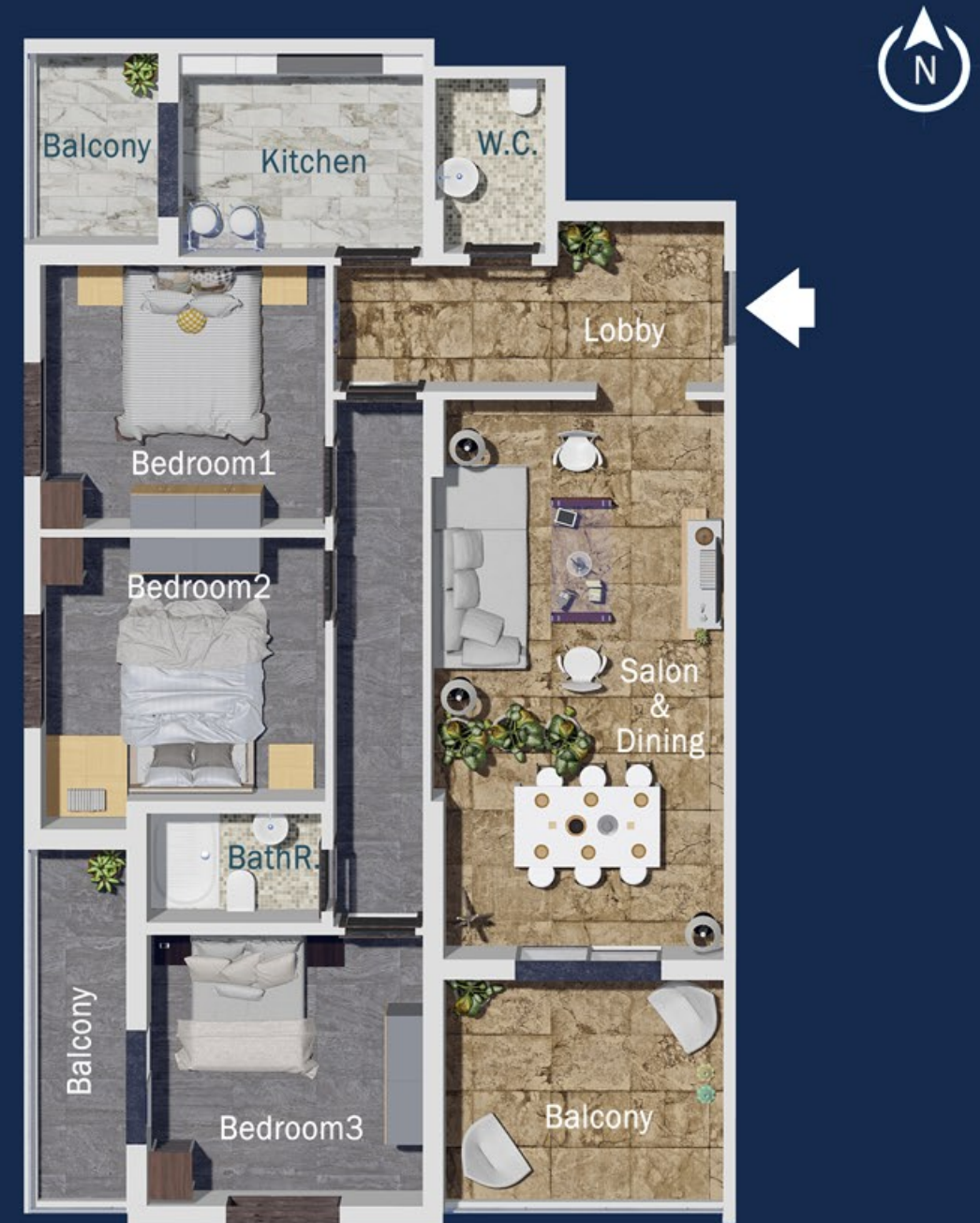



# UNIT'S DETAILS



## Apartment 02 [ TYPICAL FLOOR ]



Apartment 02 - boasts 2 bedrooms and a spacious open-plan living area to a balcony with mountainous view

109 sqm

Lobby	2.1 x 4.8 m
Salon & Dining	5.0 x 3.6 m
Balcony	2.4 x 3.4 m
Guest Bathroom	2.1 x 1.3 m
Kitchen	2.5 x 3.0 m
Bedroom 1	3.4 x 3.5 m
Bedroom 2	3.3 x 3.4 m
Main Bathroom	1.7 x 2.1 m

**Apartment Area 109 m<sup>2</sup>**

# SABTA 4461





# UNIT'S DETAILS



## Apartment 03 [ TYPICAL FLOOR ]



Apartment 03 - boasts 2 bedrooms and a spacious open-plan living area to a balcony with mountainous view

104 sqm

Lobby	2.1 x 2.7 m
Salon & Dining	5.0 x 3.6 m
Balcony	2.4 x 3.4 m
Guest Bathroom	1.6 x 1.5 m
Kitchen	2.5 x 3.0 m
Bedroom 1	3.4 x 3.5 m
Bedroom 2	3.3 x 3.4 m
Main Bathroom	1.7 x 2.1 m

**Apartment Area 104 m<sup>2</sup>**

# SABTA 4461





# UNIT'S DETAILS



## Apartment 04 [ TYPICAL FLOOR ]



Apartment 04 - boasts 3 bedrooms and a spacious open-plan living area to a balcony with mountainous view

127 sqm

Lobby	2.2 x 2.7 m
Salon & Dining	6.9 x 3.6 m
Balcony	2.9 x 3.4 m
Guest Bathroom	1.6 x 1.5 m
Kitchen	2.5 x 3.0 m
Bedroom 1	3.2 x 3.5 m
Bedroom 2	3.3 x 3.5m
Main Bathroom	1.3 x 2.1 m
Bedroom 3	3.3 x 3.4 m

**Apartment Area 127 m<sup>2</sup>**

# SABTA 4461





# UNIT'S DETAILS



## Apartment 01 [ BASEMENT FLOOR ]



Apartment 01 - boasts 3 bedrooms and a spacious open-plan living area to a balcony with mountainous view

134 sqm

Lobby	2.1 x 4.8 m
Salon & Dining	6.9 x 3.7 m
Balcony	2.9 x 3.4 m
Guest Bathroom	2.1 x 1.3 m
Kitchen	2.5 x 3.0 m
Bedroom 1	3.2 x 3.5 m
Bedroom 2	3.2 x 3.5 m
Main Bathroom	1.3 x 2.1 m
Bedroom 3	3.3 x 3.4 m

**Apartment Area 134 m<sup>2</sup>**

# SABTA 4461

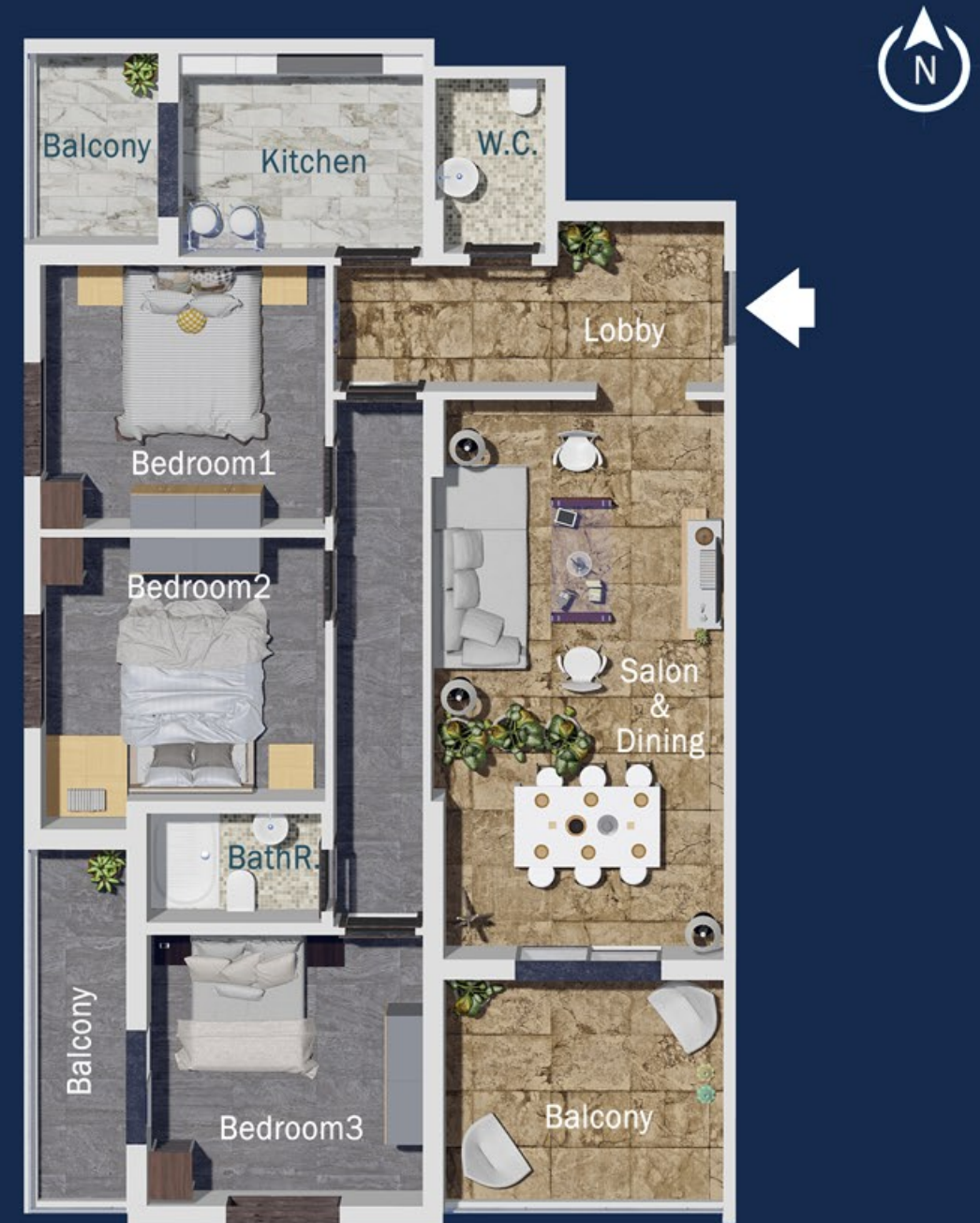



# UNIT'S DETAILS



## Apartment 02 [ BASEMENT FLOOR ]



Apartment 02 - boasts 2 bedrooms and a spacious open-plan living area to a balcony with mountainous view

108 sqm

Lobby	2.1 x 4.8 m
Salon & Dining	7.0 x 3.6 m
Guest Bathroom	2.1 x 1.3 m
Kitchen	2.5 x 3.0 m
Bedroom 1	3.4 x 3.5 m
Bedroom 2	3.3 x 3.4 m
Main Bathroom	1.7 x 2.1 m

**Apartment Area 108 m<sup>2</sup>**

# SABTA 4461





# UNIT'S DETAILS



## Apartment 03 [ BASEMENT FLOOR ]



Apartment 03 - boasts 2 bedrooms and a spacious open-plan living area to a balcony with mountainous view

104 sqm

Lobby	2.1 x 2.7 m
Salon & Dining	7.0 x 3.6 m
Guest Bathroom	1.6 x 1.5 m
Kitchen	2.5 x 3.0 m
Bedroom 1	3.4 x 3.5 m
Bedroom 2	3.3 x 3.4 m
Main Bathroom	1.7 x 2.1 m

**Apartment Area 104 m<sup>2</sup>**

# SABTA 4461





“ Luxury you can afford . . . Quality you can trust ”



Stay tuned for our latest updates on projects

