



www.sabta-lb.com



SabtaInvestment



SabtaInvestment

TO DELIVER IN JULY 2019



Mob. +961 70 333 508
Tel. +961 1 745 996/7
Fax +961 1 745 988
Mail info@sabta-lb.com

SABTA 4464





BLOCK H

BLOCK E

BLOCK F

BLOCK G





Sabta 4464, in Debbieh, is located roughly :

- 30 Km south of Beirut
- 28km north of Saida
- 6km from nearest beach resorts
- Debbieh is 450m above sea level
- Bordered by the towns of Saadiyat , Dahr Lemghara Bourjein with a breathtaking mountainous views



Beirut Arab University- Debbieh : 3 min
جامعة بيروت العربية - الدبية : ٣ دقائق



Lebanese University- Debbieh : 5 min
الجامعة اللبنانية - الدبية : ٥ دقائق



Beach Resorts- Damour : 8 min
المنتجعات البحرية - الدامور : ٨ دقائق

25MIN FROM BEIRUT

يقع مشروع ٤٤٦٤ في الدبية والتي تبعد

- ٣٠ كلم جنوب مدينة بيروت
- ٢٨ كلم شمال مدينة صيدا
- ٦ كلم عن المنتجعات البحرية
- ترتفع بلدة الدبية ٤٥٠ مترا عن سطح البحر
- تحدها كل من بلدتي السعديات و ضهر المغارة من الشرق والجنوب، بلدة البرجين من الغرب والشمال

THE LOCATION





SABTA projects are located with 25 minutes' drive from Beirut, in a peaceful surrounding overlooking mountainous view.

Near all the facilities set to be :

- 3mins from Beirut Arab University
- 5mins from Lebanese university

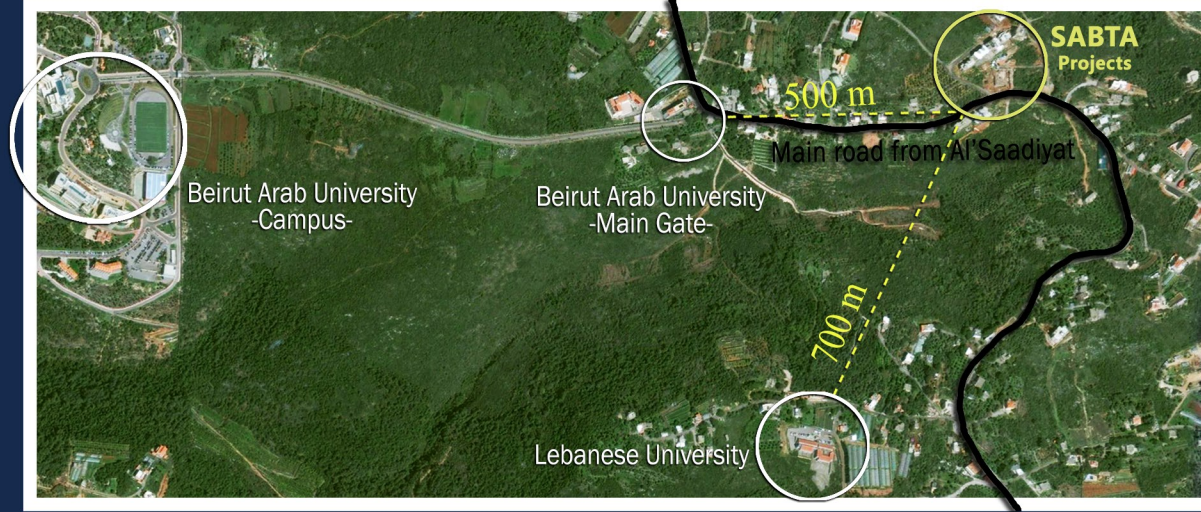

THE LOCATION

مشاريع سبتا بتصاميمها الحديثة مؤلفة من ٤ طوابق و تتميز:

- بوقوعها على الطريق العام
- بقربها من الجامعة العربية والجامعة اللبنانية في منطقة الدبية
- باطلالتها على الجبل بحيث تجعل منها بيئة مثالية لحياة هادئة.



SABTA 4464



PROJECT'S INTRODUCTION



PROJECT'S BRIEF



Our residential units boasts in :

- 28 Apartments
- 4 Floors
- 4 Blocks
- 4 Parking Entrances

يتألف المشروع من :

- ٢٨ شقة سكنية
- ٤ طوابق
- ٤ بلوكات
- ٤ مداخل لمواقف السيارات

SABTA 4464



PROJECT'S FLOOR PLAN



- Each block holds in a total of 4 floors
- Each floor combines a different set of apartments from 1 Apartment/floor, to 2 Apartments/floor

- تتوزع الشقق في البلوك الواحد على 4 طوابق
- يشمل الطابق شقة واحدة كما في بلوك [E] أو شقتين كما في [F, G و H]

APARTMENTS AREAS TYPICAL FLOOR

Block E	Apartment 01	2 Bedrooms	145m ²
Block F	Apartment 01	2 Bedrooms	126m ²
Block F	Apartment 02	2 Bedrooms	122m ²
Block G	Apartment 01	2 Bedrooms	122m ²
Block G	Apartment 02	2 Bedrooms	127m ²
Block H	Apartment 01	2 Bedrooms	133m ²
Block H	Apartment 02	2 Bedrooms	131m ²

SABTA 4464

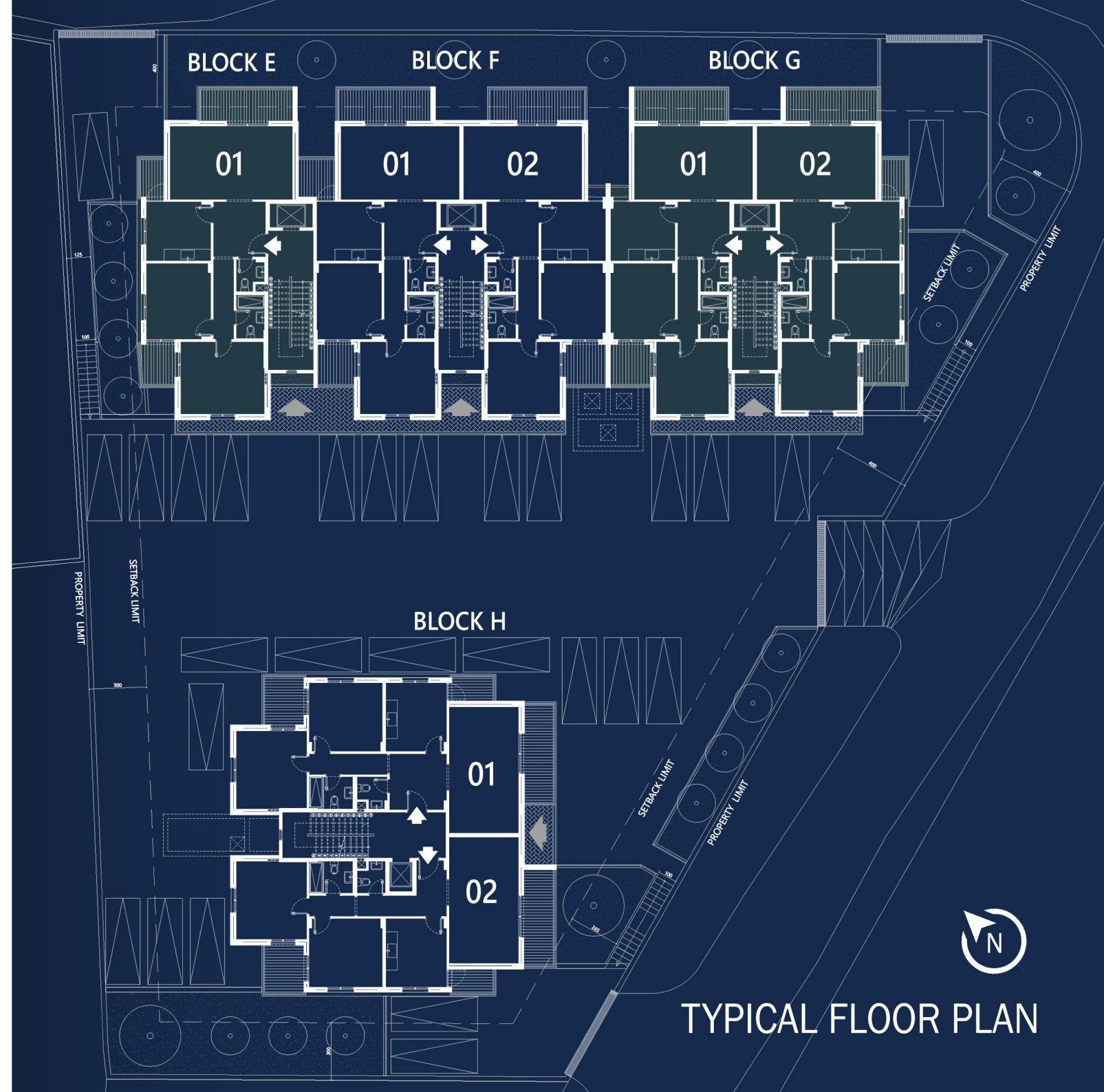

TYPICAL FLOOR PLAN

UNIT'S DETAILS



Apartment 01 - Block | E [TYPICAL FLOOR]

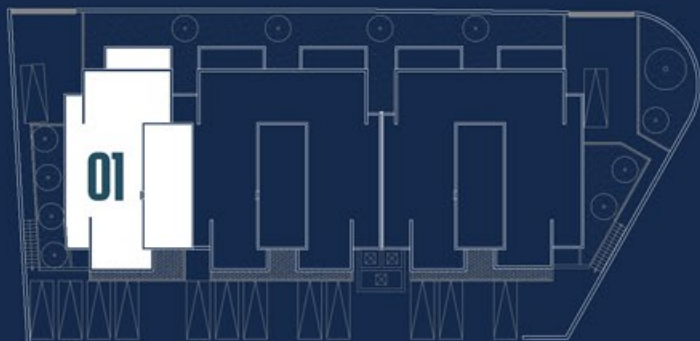

Apartment 01 - Block E boasts 2 bedrooms and a spacious open-plan living area to a balcony with mountainous view

145 sqm

Lobby	2.7 x 2.9 m
Salon & Dining	6.4 x 3.8 m
Balcony	4.8 x 1.6 m
Guest Bathroom	1.5 x 1.7 m
Kitchen	3.4 x 3.1 m
Bedroom 1	3.4 x 4.0 m
Bedroom 2	4.4 x 3.8 m
Main Bathroom	1.5 x 2.3 m

Apartment Area 145 m²

SABTA 4464



UNIT'S DETAILS



Apartment 01&02 - Block | F [TYPICAL FLOOR]

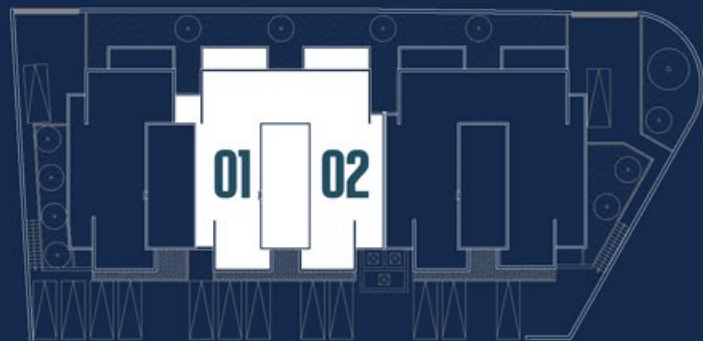

Apartments 01&02 - Block F each boasts 2 bedrooms & a spacious open-plan living area to a balcony with mountainous view

Lobby	2.7 x 2.9 m	2.7 x 2.9 m
Salon & Dining	6.2 x 3.8 m	6.2 x 3.8 m
Balcony	4.9 x 1.6 m	4.7 x 1.6 m
Guest Bathroom	1.5 x 1.7 m	1.5 x 1.7 m
Kitchen	3.4 x 3.1 m	3.4 x 3.1 m
Bedroom 1	3.4 x 4.0 m	3.4 x 4.0 m
Bedroom 2	3.9 x 3.8 m	3.8 x 3.8 m
Main Bathroom	1.5 x 2.3 m	1.5 x 2.3 m

Apartment Area 126 m² 122 m²

01

02

SABTA 4464



UNIT'S DETAILS



Apartment 01&02 - Block | G [TYPICAL FLOOR]

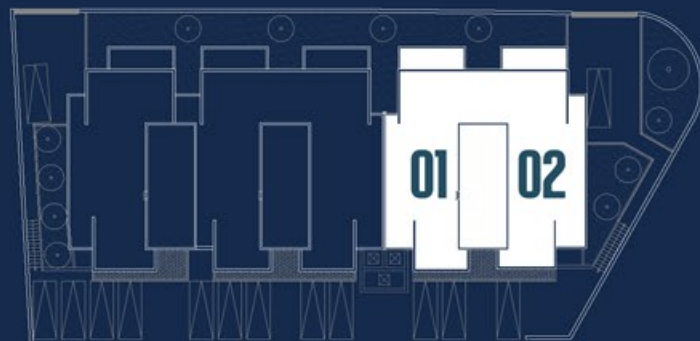

Apartments 01&02 - Block G each boasts 2 bedrooms & a spacious open-plan living area to a balcony with mountainous view

Lobby	2.7 x 2.9 m	2.7 x 2.9 m
Salon & Dining	6.2 x 3.8 m	6.2 x 3.8 m
Balcony	4.9 x 1.6 m	4.8 x 1.6 m
Guest Bathroom	1.5 x 1.7 m	1.5 x 1.7 m
Kitchen	3.4 x 3.1 m	3.4 x 3.1 m
Bedroom 1	3.4 x 4.0 m	3.4 x 4.0 m
Bedroom 2	3.8 x 3.8 m	4.0 x 3.6 m
Main Bathroom	1.5 x 2.3 m	1.5 x 2.3 m

Apartment Area 122 m² 127 m²

01

02

SABTA 4464



UNIT'S DETAILS



Apartment 01&02 - Block | H [TYPICAL FLOOR]

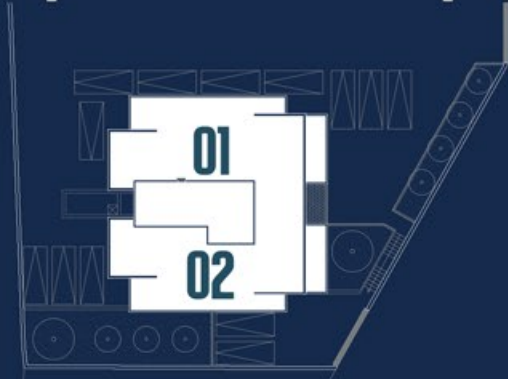

Apartments 01&02 - Block H each boasts 2 bedrooms & a spacious open-plan living area to a balcony with mountainous view

Lobby	3.0 x 2.9 m	1.1 x 2.9 m
Salon & Dining	6.6 x 3.6 m	6.6 x 3.6 m
Balcony	5.0 x 1.5 m	5.1 x 1.5 m
Guest Bathroom	1.6 x 1.7 m	1.5 x 1.7 m
Kitchen	3.2 x 3.6 m	3.2 x 3.6 m
Bedroom 1	3.8 x 3.6 m	3.8 x 3.6 m
Bedroom 2	3.7 x 4.1 m	3.7 x 4.1 m
Main Bathroom	2.3 x 1.7 m	2.3 x 1.7 m

Apartment Area **133 m²** **131 m²**

01

02

SABTA 4464



UNIT'S DETAILS



SABTA 4464

Apartment 01 - Block | E [BASEMENT FLOOR]

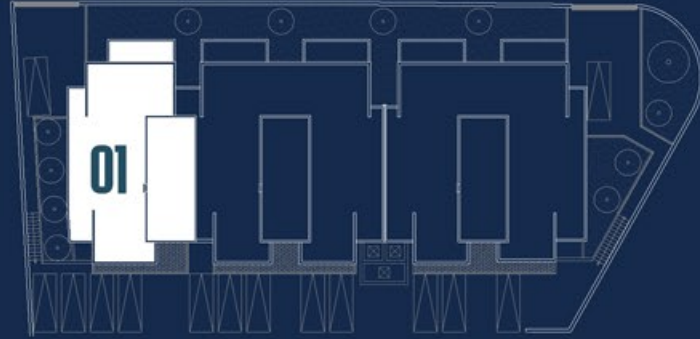

Apartment 01 - Block E boasts 2 bedrooms & a spacious open-plan living area to a balcony with mountainous view

135 sqm

Lobby	2.7 x 2.9 m
Salon & Dining	6.4 x 3.8 m
Balcony	4.9 x 0.6 m
Guest Bathroom	1.5 x 1.7 m
Kitchen	3.4 x 3.1 m
Bedroom 1	3.4 x 4.0 m
Bedroom 2	4.4 x 3.8 m
Main Bathroom	1.5 x 2.3 m

Apartment Area 135 m²



UNIT'S DETAILS



Apartment 01&02 - Block | F [BASEMENT FLOOR]

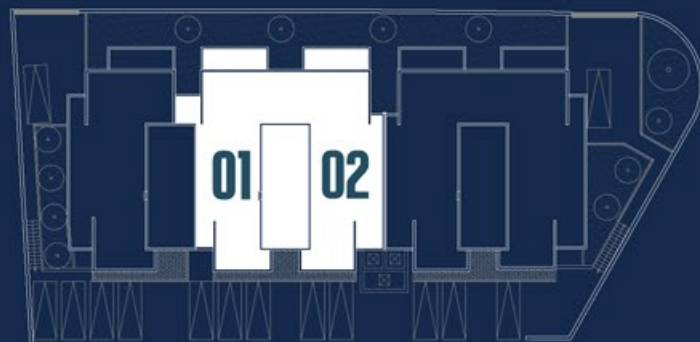

Apartments 01&02 - Block F each boasts 2 bedrooms & a spacious open-plan living area to a balcony with mountainous view

Lobby	2.7 x 2.1 m	2.7 x 2.1 m
Salon & Dining	3.9 x 3.8 m	3.9 x 3.8 m
Balcony	4.9 x 0.6 m	4.9 x 0.6 m
Guest Bathroom	1.5 x 1.7 m	1.5 x 1.7 m
Kitchen	2.2 x 3.8 m	2.2 x 3.8 m
Bedroom 1	3.4 x 4.7 m	3.4 x 4.7 m
LivingRoom	3.5 x 2.4 m	3.5 x 2.4 m
Bedroom 2	3.8 x 3.9 m	3.8 x 3.8 m
Main Bathroom	1.5 x 2.3 m	1.5 x 2.3 m

Apartment Area	112 m²	108 m²
	01	02



SABTA 4464

UNIT'S DETAILS



SABTA 4464

Apartment 01&02 - Block | G [BASEMENT FLOOR]

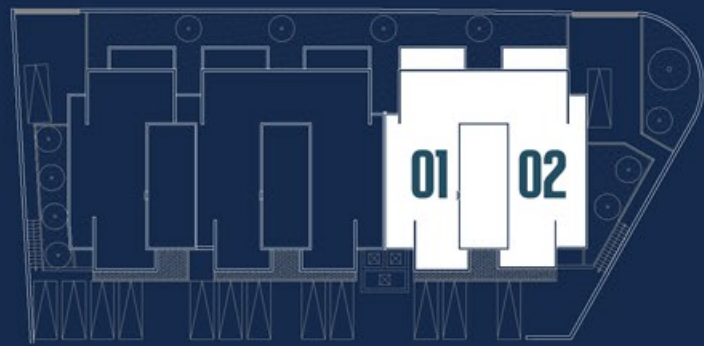

Apartments 01&02 - Block G each boasts 2 bedrooms & a spacious open-plan living area to a balcony with mountainous view

Lobby	2.7 x 2.1 m	2.7 x 2.9 m
Salon & Dining	3.9 x 3.8 m	6.2 x 3.8 m
Balcony	4.9 x 0.6 m	4.9 x 0.6 m
Guest Bathroom	1.5 x 1.7 m	1.5 x 1.7 m
Kitchen	2.2 x 3.8 m	3.4 x 3.1 m
Bedroom 1	3.4 x 4.7 m	3.4 x 4.0 m
LivingRoom	3.5 x 2.4 m	-
Bedroom 2	3.8 x 3.9 m	4.0 x 3.6 m
Main Bathroom	1.5 x 2.3 m	1.5 x 2.3 m

Apartment Area	109 m²	122 m²
	01	02

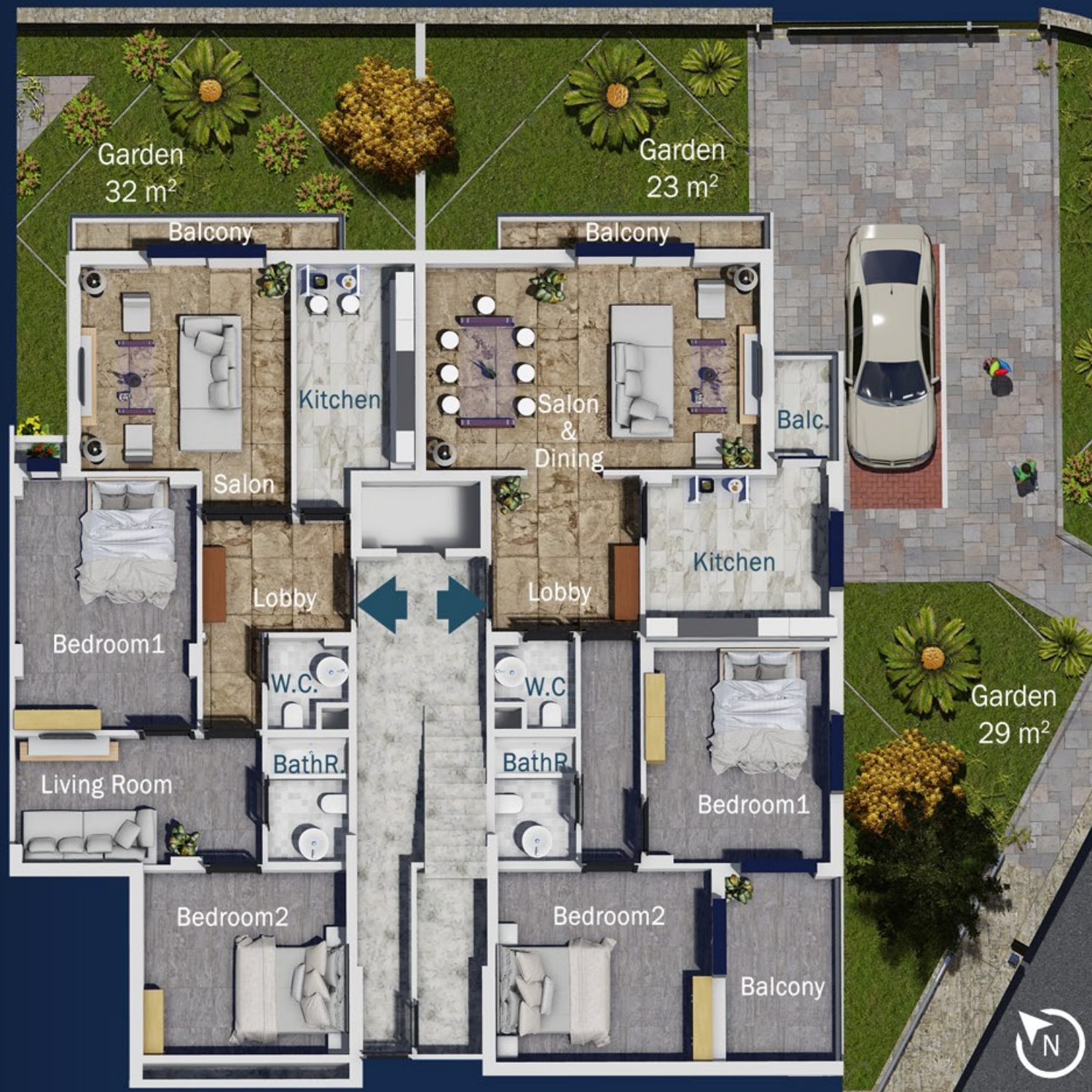

UNIT'S DETAILS



Apartment 01&02 - Block | H [BASEMENT FLOOR]

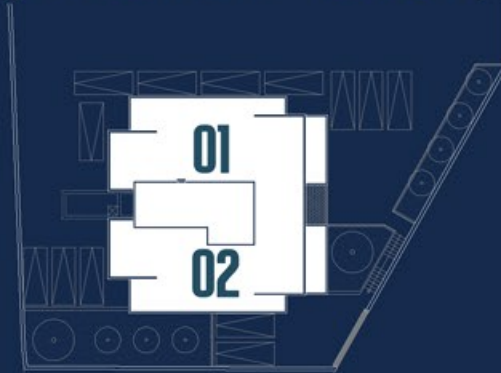

Apartments 01&02 - Block H each boasts 2 bedrooms and a spacious open-plan living area to a balcony with mountainous view

Lobby	3.0 x 2.9 m	1.1 x 2.9 m
Salon & Dining	5.4 x 3.6 m	5.4 x 3.6 m
Balcony	5.0 x 1.5 m	5.0 x 1.5 m
Guest Bathroom	1.6 x 1.7 m	1.5 x 1.7 m
Kitchen	3.2 x 3.6 m	3.2 x 3.6 m
Bedroom 1	3.8 x 3.6 m	3.8 x 3.6 m
Bedroom 2	3.7 x 4.1 m	3.7 x 4.1 m
Main Bathroom	2.3 x 1.7 m	2.3 x 1.7 m

Apartment Area **125 m²** **120 m²**

01

02

SABTA 4464



“ Luxury you can afford . . . Quality you can trust ”



Stay tuned for our latest updates on projects

